



Planning Act 2008
Infrastructure Planning
(Applications Prescribed
Forms and Procedure)
Regulations 2009

Regulation 5(2)(i)

North Lincolnshire Green Energy Park

Volume 4

4.2 Land Plans

PINS reference: EN010116

May 2022

Revision number: 0



The North Lincolnshire Green Energy Park Development Consent Order

4.2 Land Plans

Date: May 2022

PINS reference: EN010116

Application Document Reference: 4.2

Author: Ardent

CONTENTS

CONTENTS	1
1. INTRODUCTION	2
1.1 General.....	2
2. SCHEDULE OF PLANS INCLUDED IN THIS APPLICATION DOCUMENT	3

1. INTRODUCTION

1.1 General

1.1.1 The following Plans have been prepared to accompany the application for a Development Consent Order (DCO), made by the Applicant to the Secretary of State (SoS) via the Planning Inspectorate (the Inspectorate).

1.1.2 A detailed description of the Project can be found in Chapter 3 of the ES (**Document Reference 6.2.3**).

1.1.3 These Plans comprise part of the suite of Application documentation and are included in the Application in compliance with Regulation 5(2)(i) of the Infrastructure Planning (Applications: Prescribed Forms and Procedure) Regulations 2009 (the 2009 Regulations), which requires:

(i) a land plan identifying—

(i) the land required for, or affected by, the proposed development;

(ii) where applicable, any land over which it is proposed to exercise powers of compulsory acquisition or any right to use land;

(iii) any land in relation to which it is proposed to extinguish easements, servitudes and other private rights; and

(iv) where the land includes special category land and replacement land, that special category and replacement land;

1.1.4 These Plans are also being submitted under Regulation 5(4) of the 2009 Regulations which states:

"Where a plan comprises three or more separate sheets a key plan must be provided showing the relationship between the different sheets."

1.1.5 To assist the interpretation of these Plans, a key plan shows ten separate sheets which cover the Order Limits. Where there are no works shown on a separate sheet, "Sheet X Not Used" is shown on the key plan. Only the sheets showing relevant information are provided.

1.1.6 Two alternative route options are proposed to the eastern most extent of the northern DHPWN. At the roundabout junction with the A4130 (Normanby Road):

- Option A –the route passes south towards the built-up urban centre of Scunthorpe via Normanby Road, where the route remains lined on both sides by residential and industrial areas.
- Option B –the route continues east on the A1077 until the junction with Bessemer Way to the south. The route will follow

Bessemer Way until the junction with Warren Road turning due west to meet the Normanby Road.

The Land Plans present both options as Sheet 10A and Sheet 10B.

- 1.1.7 These Plans are part of the Application documentation and should be read alongside and are informed by the other Application documents.

2. SCHEDULE OF PLANS INCLUDED IN THIS APPLICATION DOCUMENT

Drawing Number	Drawing Title	Revision
NLGEP- ARD- XX- XX- DR- Z - 0000	Application Document Reference No.4.2 Key Plan	P0
NLGEP- ARD- XX- XX- DR- Z - 0001	Application Document Reference No.4.2 Land Plan Sheet 1 of 10	P0
NLGEP- ARD- XX- XX- DR- Z - 0002	Application Document Reference No.4.2 Land Plan Sheet 2 of 10	P0
NLGEP- ARD- XX- XX- DR- Z - 0003	Application Document Reference No.4.2 Land Plan Sheet 3 of 10	P0
NLGEP- ARD- XX- XX- DR- Z - 0004	Application Document Reference No.4.2 Land Plan Sheet 4 of 10	P0
NLGEP- ARD- XX- XX- DR- Z - 0005	Application Document Reference No.4.2 Land Plan Sheet 5 of 10	P0
NLGEP- ARD- XX- XX- DR- Z - 0006	Application Document Reference No.4.2 Land Plan Sheet 6 of 10	P0
NLGEP- ARD- XX- XX- DR- Z - 0007	Application Document Reference No.4.2 Land Plan Sheet 7 of 10	P0
NLGEP- ARD- XX- XX- DR- Z - 0008	Application Document Reference No.4.2 Land Plan Sheet 8 of 10	P0
NLGEP- ARD- XX- XX- DR- Z - 0009	Application Document Reference No.4.2 Land Plan Sheet 9 of 10	P0
NLGEP- ARD- XX- XX- DR- Z - 0010	Application Document Reference No.4.2 Land Plan Sheet 10 of 10	P0
NLGEP- ARD- XX- XX- DR- Z - 0010A	Application Document Reference No.4.2 Land Plan Sheet 10A of 10	P0
NLGEP- ARD- XX- XX- DR- Z - 0010B	Application Document Reference No.4.2 Land Plan Sheet 10B of 10	P0

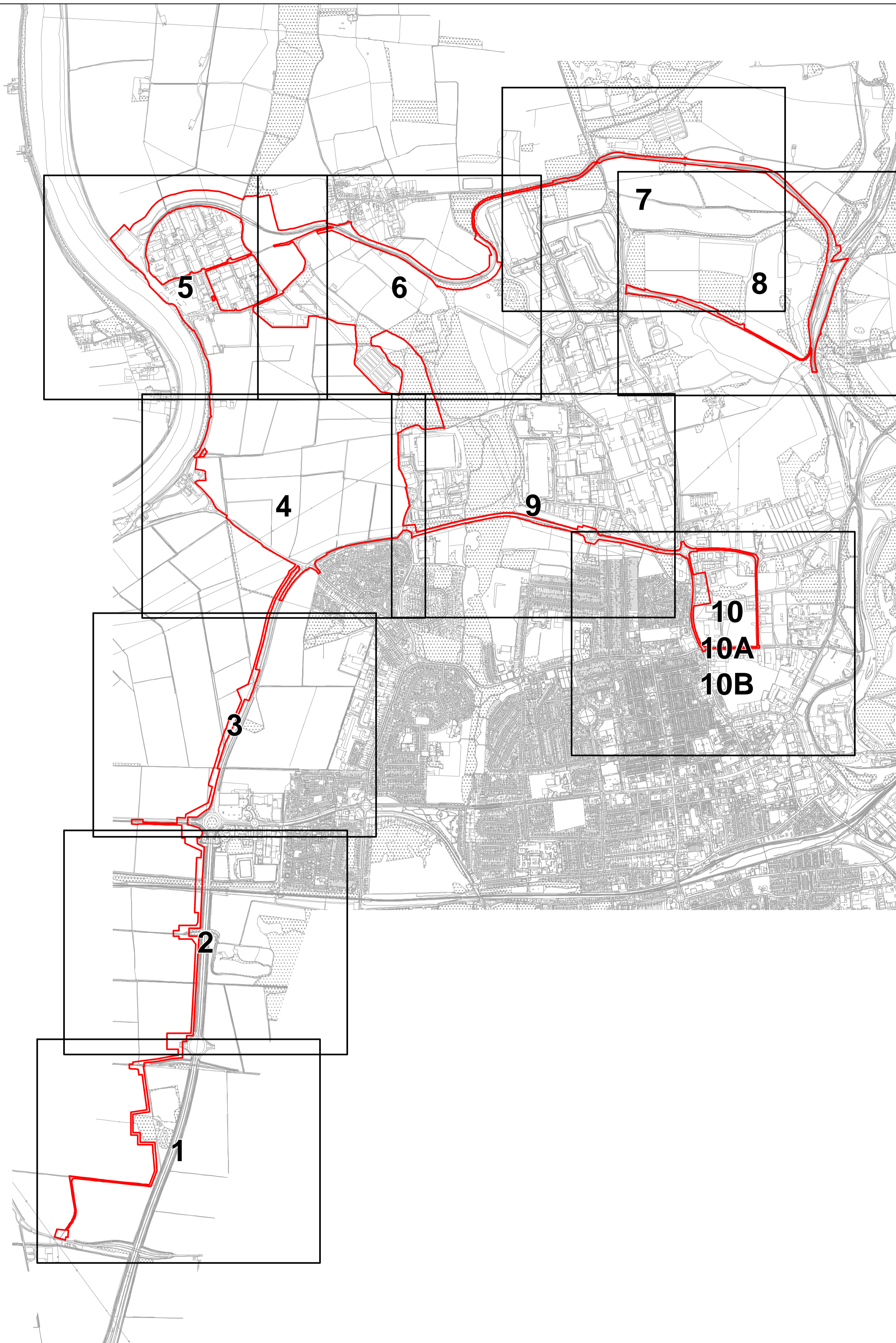

Planning Act 2008
The Infrastructure Planning (Applications: Prescribed forms and Procedure)
Regulations 2009
Regulation: 5(2)(f)



Notes
© Crown copyright and database rights 2021 Ordnance Survey 100035409. You are permitted to use this data solely to enable you to respond to, or interact with, the organisation that provided you with the data. You are not permitted to copy, sub-licence, distribute or sell any of this data to third parties in any form.
Contains OS data © Crown Copyright and database right 2020

Key
Order Land - the area within which powers of compulsory acquisition and to take temporary possession can be exercised
Sheets

00	14/03/2022	IM	GE	RB	LH
Rev	Date	Drawn	Checked	Rev'd	App'd

DCO SUBMISSION

Project Stage

INFORMATION

Status of Drawing

Client



NORTH LINCOLNSHIRE GREEN ENERGY PARK
Level 33, Euston Tower, 286 Euston Road, London, NW1 3DP

LD A DESIGN GSDA ERM FICHTNER CONSULTING BUSINESS PARTNERS

BURO HAPPOLD northern planners bowland ecology

Client: NORTH LINCOLNSHIRE GREEN ENERGY PARK LTD
 Consultant: ARDENT
 Project: NORTH LINCOLNSHIRE GREEN ENERGY PARK
 Orig Title: APPLICATION DOCUMENT REFERENCE NO. 4.2 KEY PLAN

Planning Inspectorate No:	Scale: A1
EN010116	1:15000
Drawn/Designed By: I.MAXIM	Checked By: G.EACOCK
Approved By: R.BRADE	
Drawing No: NLGEP-ARD-XX-XX-DR-Z-0000	Revision: 00

C:\Users\m\Documents\Management\GEP\Projects - Documents\North Lincoln Green Energy Park\PE - GIS & CAD\Drawings\ARD - NLGEP\MapInfo and Parcel\GEP-ARD-XX-XX-DR-Z-0000.mxd

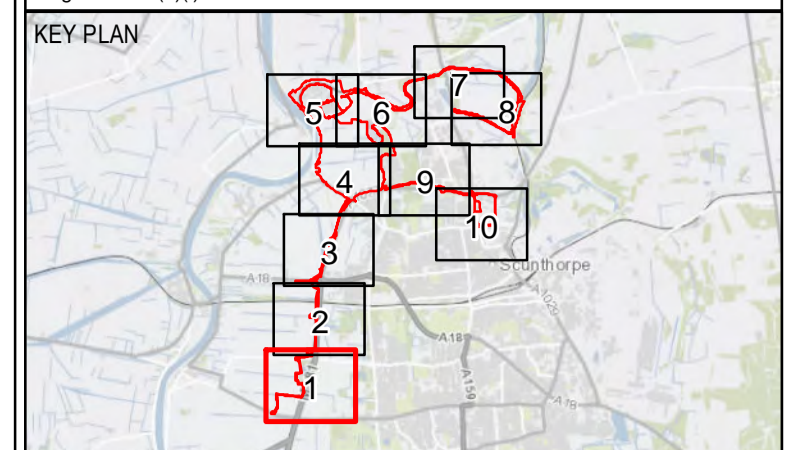
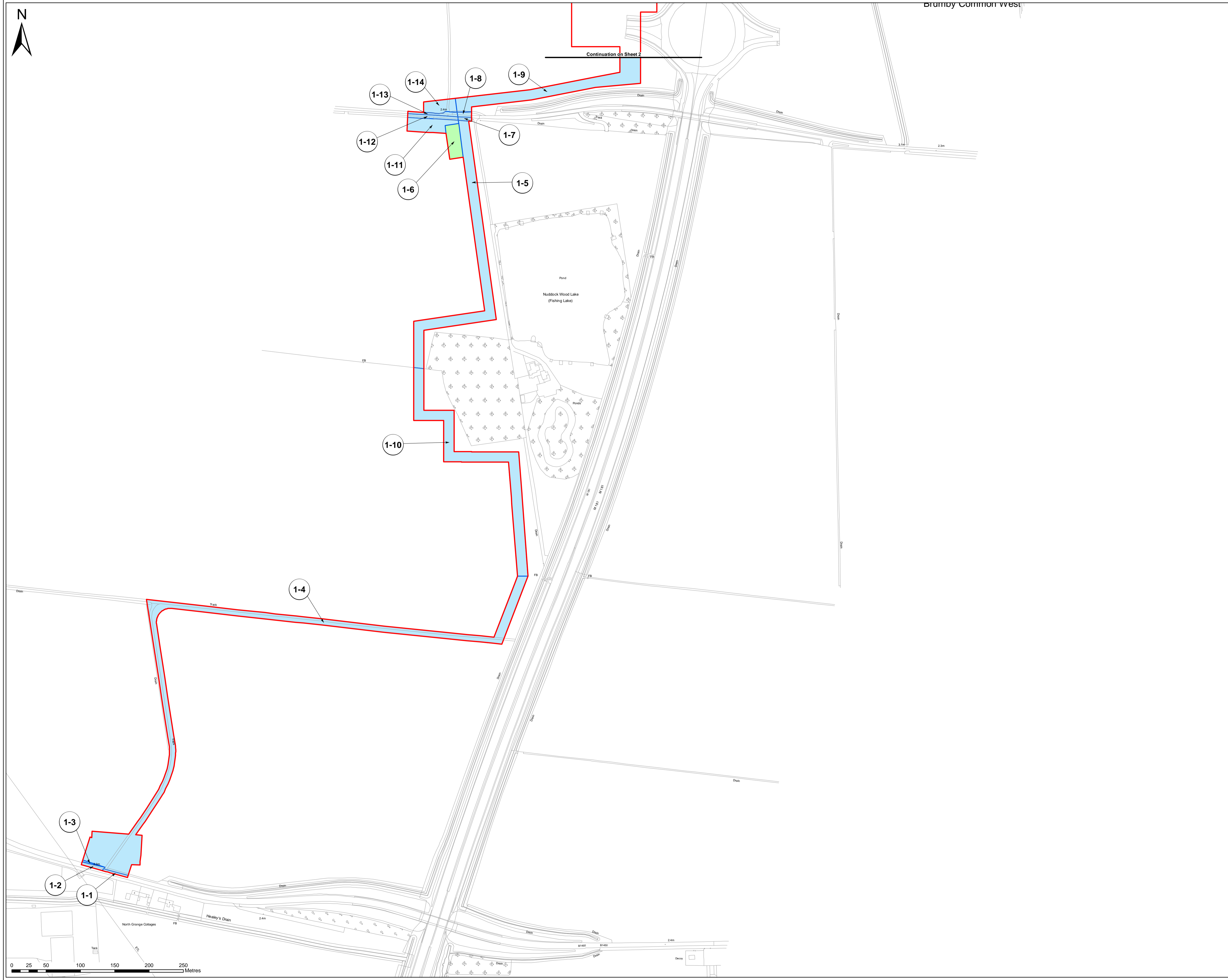

Notes
© Crown copyright and database rights 2021 Ordnance Survey 100035409. You are permitted to use this data solely to enable you to respond to, or interact with, the organisation that provided you with the data. You are not permitted to copy, sub-licence, distribute or sell any of this data to third parties in any form.
Contains OS data © Crown Copyright and database right 2020

Key

- Order Land - the area within which powers of compulsory acquisition and to take temporary possession can be exercised
- Order Land - Freehold to be compulsorily acquired and in relation to which it is proposed to extinguish easements, servitudes and other private rights.
- Order Land - Temporary use of land and in relation to which it is proposed to extinguish easements, servitudes and other private rights.
- Order Land - New Rights to be compulsorily acquired and in relation to which it is proposed to extinguish easements, servitudes and other private rights.
- No Acquisition
- Special Category Land

00	14/03/2022					IM	GE	RB	LH
Rev	Date		Drawn	Chk'd	Rev'd				

DCO SUBMISSION

Project Stage

INFORMATION

Status of Drawing

Client

NORTH LINCOLNSHIRE GREEN ENERGY PARK LTD
Level 33, Euston Tower, 298 Euston Road, London, NW1 3DP

LD A DESIGN | GSDA | ERM | FICHTNER

BURO HAPPOLD | northern planners | bowland ecology | arcadis

Client: NORTH LINCOLNSHIRE GREEN ENERGY PARK LTD
Consultant: ARDENT
Project: NORTH LINCOLNSHIRE GREEN ENERGY PARK
Orig Title: APPLICATION DOCUMENT REFERENCE NO. 4.2 LAND PLAN SHEET 1 OF 10

Planning Inspectorate No:	Scale: A1	
EN010116	1:2500	
Drawn/Designed By:	Checked By:	Approved By:
IMAXIM	G.EACOCK	R.BRADE
Drawing No:	Revision	
NLGEP-ARD-XX-XX-DR-Z-0001	00	

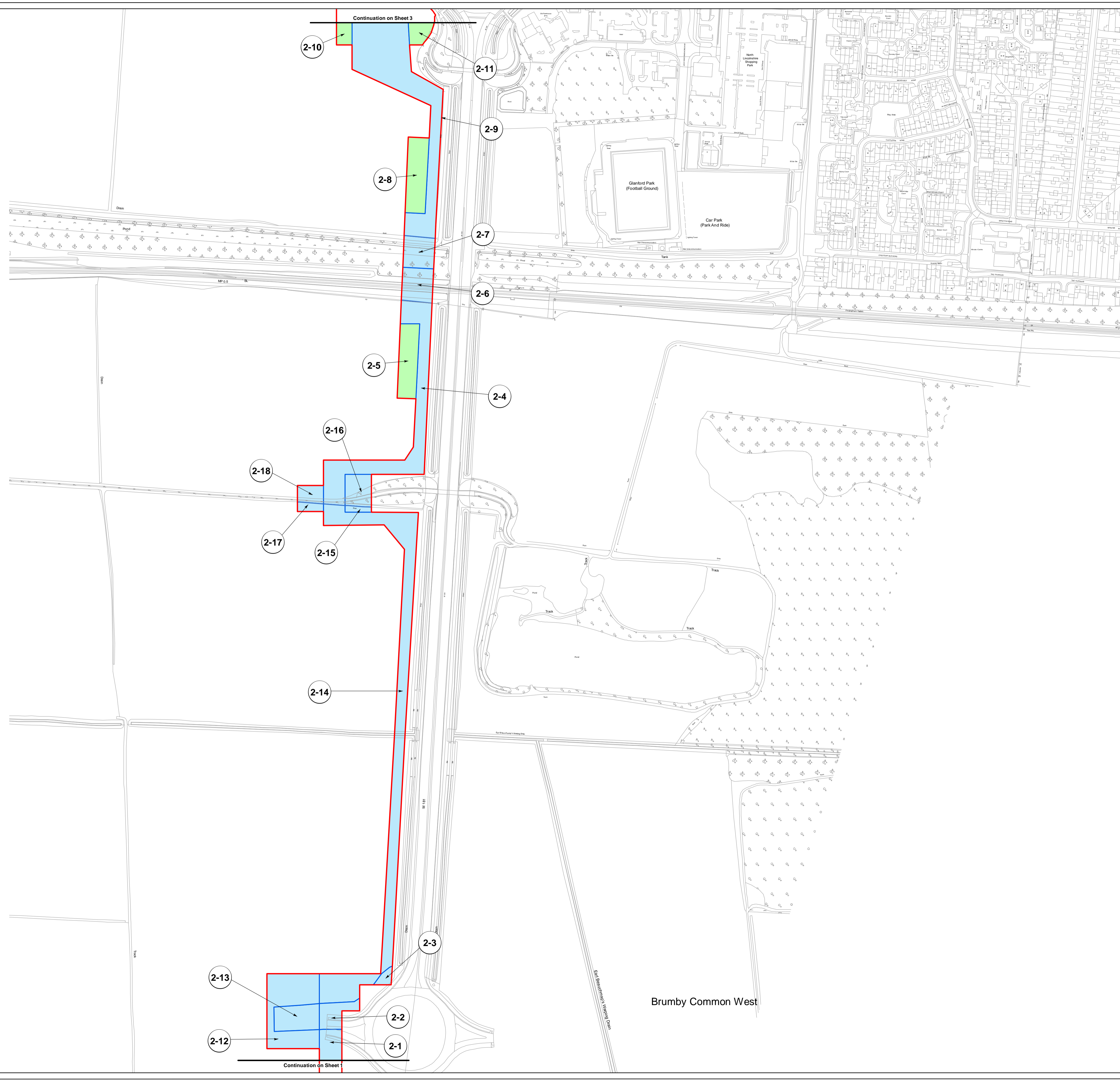
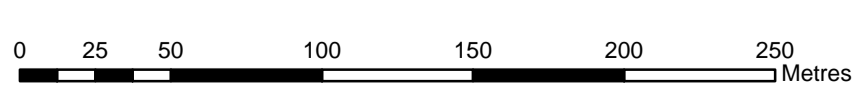

Planning Act 2008
The Infrastructure Planning (Applications: Prescribed forms and Procedure) Regulations 2009
Regulation: 5(2)(f)

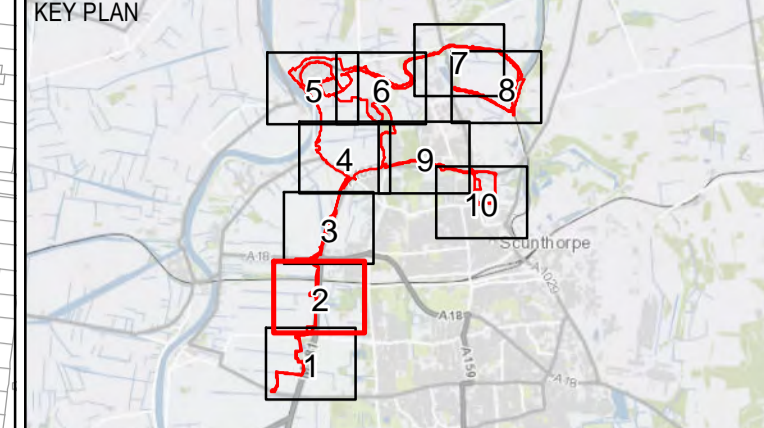

Notes
© Crown copyright and database rights 2021 Ordnance Survey 100035409. You are permitted to use this data solely to enable you to respond to, or interact with, the organisation that provided you with the data. You are not permitted to copy, sub-licence, distribute or sell any of this data to third parties in any form.
Contains OS data © Crown Copyright and database right 2020

- Key
- Order Land - the area within which powers of compulsory acquisition and to take temporary possession can be exercised
 - Order Land - Freehold to be compulsorily acquired and in relation to which it is proposed to extinguish easements, servitudes and other private rights.
 - Order Land - Temporary use of land and in relation to which it is proposed to extinguish easements, servitudes and other private rights.
 - Order Land - New Rights to be compulsorily acquired and in relation to which it is proposed to extinguish easements, servitudes and other private rights.
 - No Acquisition
 - Special Category Land

00	14/03/2022	IM	GE	RB	LH
Rev	Date	Drawn	CHK'd	Rev'd	App'd

DCO SUBMISSION

INFORMATION

Client



Level 33, Euston Tower, 286 Euston Road, London, NW1 3DP

LD A DESIGN GSDA ERM FICHTNER CONSULTING BUSINESS PARTNERS

BURO HAPPOLD northern planners bowland ecology ardent

Client: NORTH LINCOLNSHIRE GREEN ENERGY PARK LTD
 Consultant: ARDENT
 Project: NORTH LINCOLNSHIRE GREEN ENERGY PARK
 Orig Title: APPLICATION DOCUMENT REFERENCE NO. 4.2 LAND PLAN SHEET 2 OF 10

Planning Inspectorate No:	Scale: A1
EN010116	1:2500
Drawn/Designed By: I.MAXIM	Checked By: G.EACOCK
Approved By: R.BRADE	Revision: 00
Drawing No: NLGEP-ARD-XX-XX-DR-Z-0002	

C:\Users\m\Documents\Management\GP\Projects - Documents\North Lincoln Green Energy Park\PE - GIS & CAD\Drawings\ARD - NLGEP\MapInfo\and\Parent\GP-ARD-XX-XX-DR-Z-0002.mxd



Planning Act 2008
The Infrastructure Planning (Applications: Prescribed forms and Procedure) Regulations 2009
Regulation: 5(2)(b)

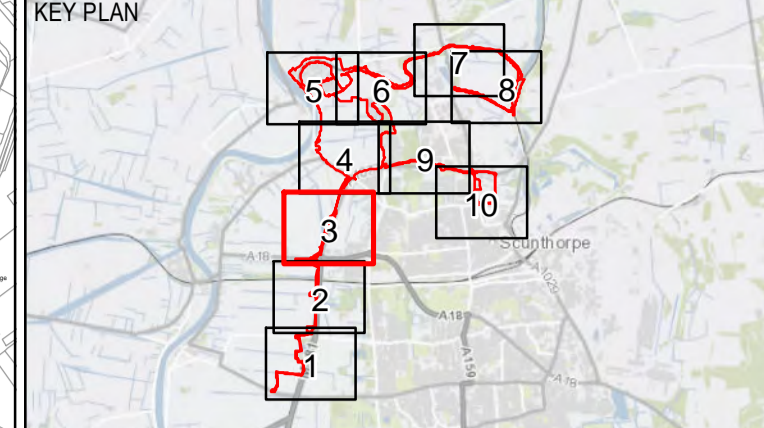

Notes
© Crown copyright and database rights 2021 Ordnance Survey 100035409. You are permitted to use this data solely to enable you to respond to, or interact with, the organisation that provided you with the data. You are not permitted to copy, sub-licence, distribute or sell any of this data to third parties in any form.
Contains OS data © Crown Copyright and database right 2020

- Key
- Order Land - the area within which powers of compulsory acquisition and to take temporary possession can be exercised
 - Order Land - Freehold to be compulsorily acquired and in relation to which it is proposed to extinguish easements, servitudes and other private rights.
 - Order Land - Temporary use of land and in relation to which it is proposed to extinguish easements, servitudes and other private rights.
 - Order Land - New Rights to be compulsorily acquired and in relation to which it is proposed to extinguish easements, servitudes and other private rights.
 - No Acquisition
 - Special Category Land

00	14/03/2022	IM	GE	RB	LH
Rev	Date	Drawn	Checked	Rev'd	App'd

DCO SUBMISSION

INFORMATION

Client



NORTH LINCOLNSHIRE GREEN ENERGY PARK
Level 33, Euston Tower, 286 Euston Road, London, NW1 3DP

LD A DESIGN GSDA ERM FICHTNER CONSULTING BUSINESS PARTNERS

BURO HAPPOLD northern planners bowland ecology arcadis

Client: *NORTH LINCOLNSHIRE GREEN ENERGY PARK LTD*
 Consultant: *ARDENT*
 Project: **NORTH LINCOLNSHIRE GREEN ENERGY PARK**
 Dwg Title: **APPLICATION DOCUMENT REFERENCE NO. 4.2 LAND PLAN SHEET 3 OF 10**

Planning Inspectorate No:	EN010116	Scale@A1:	1:2500
Drawn/Designed By:	IMAXIM	Checked By:	G.EACOCK
Approved By:	R.BRADE	Revision:	00
Drawing No:	NLGEP-ARD-XX-XX-DR-Z-0003		

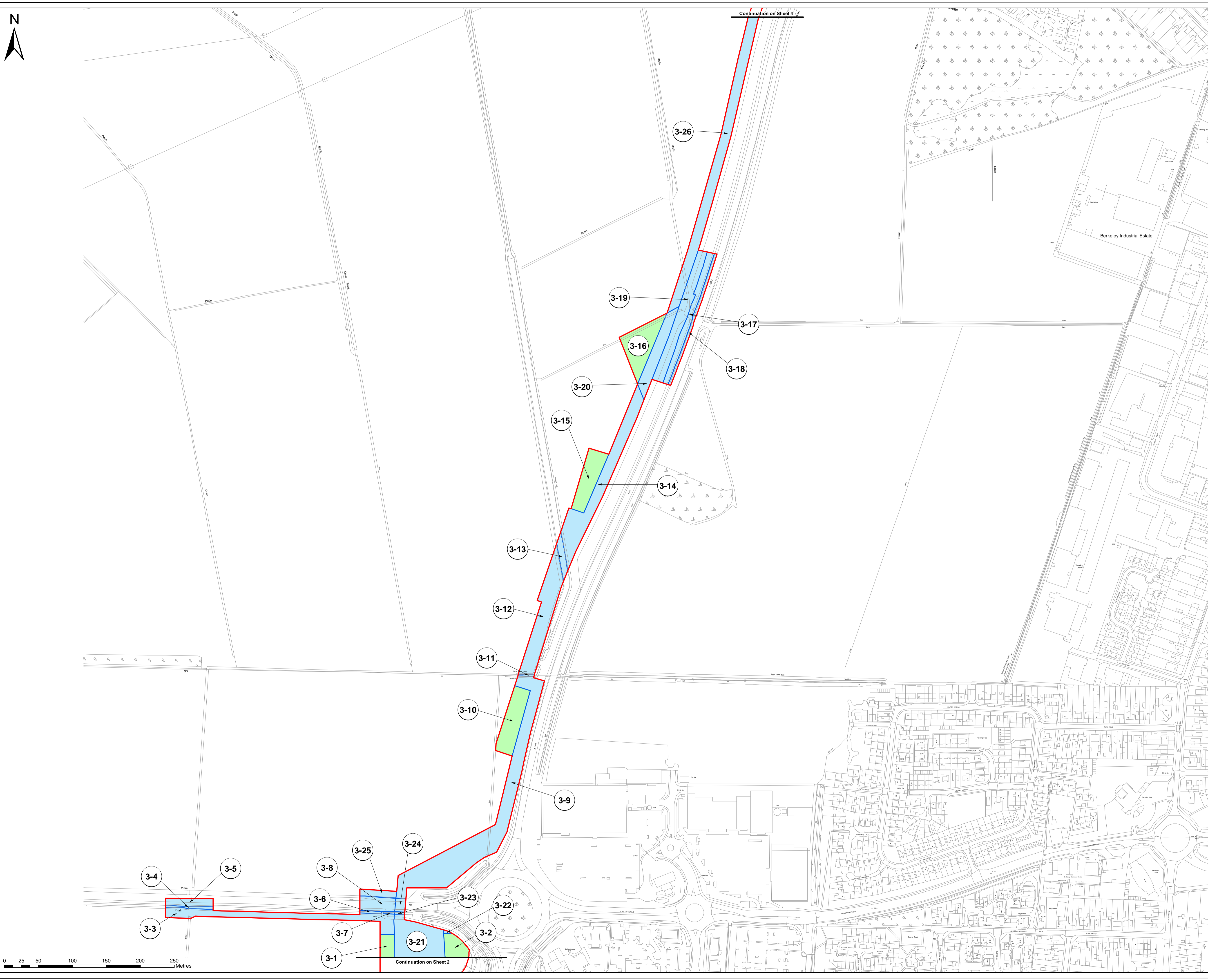

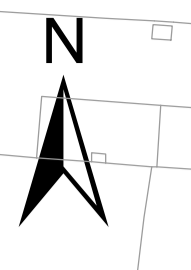
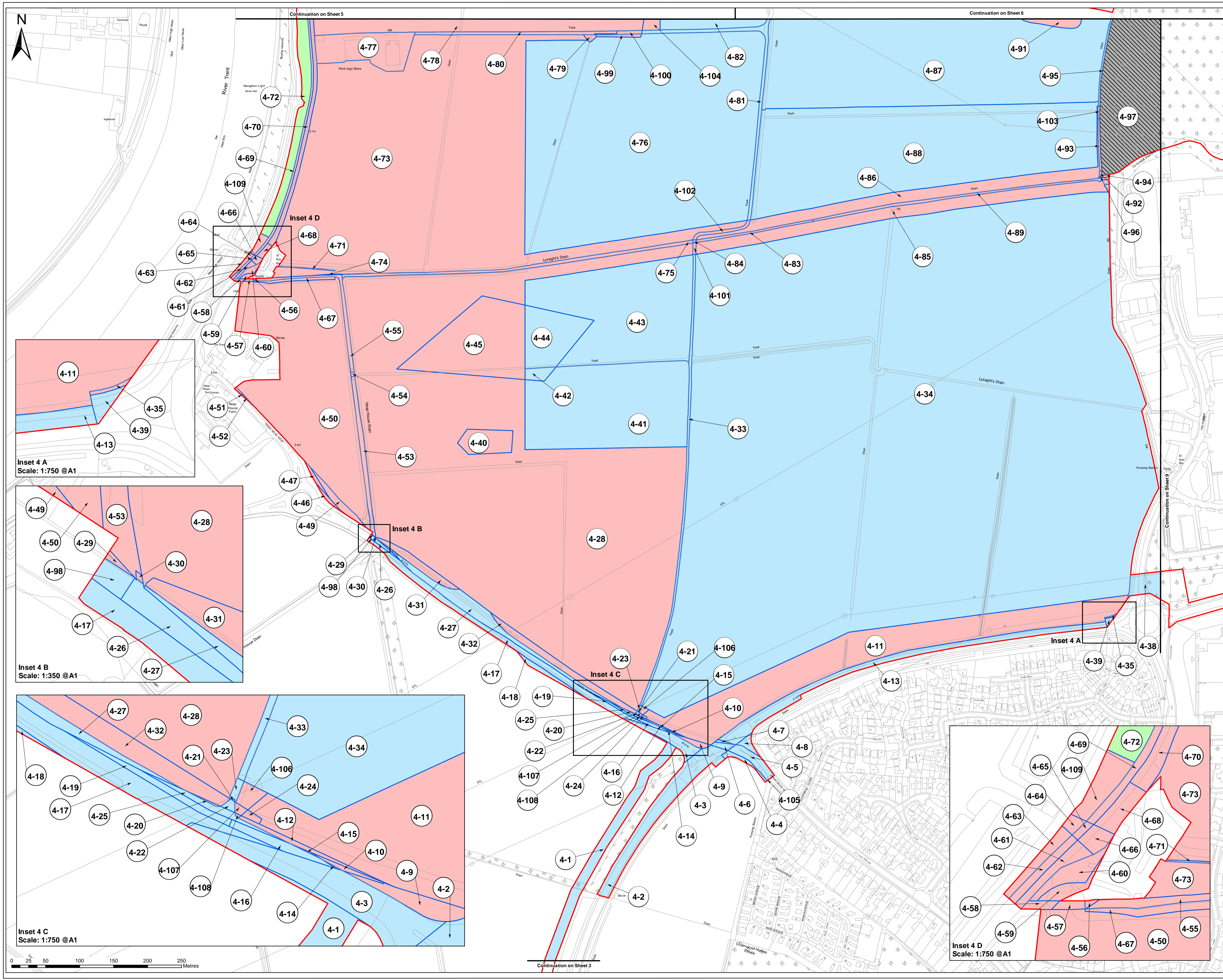

Planning Act 2008
The Infrastructure Planning (Applications: Prescribed forms and Procedure) Regulations 2009
Regulation: 5(2)(b)

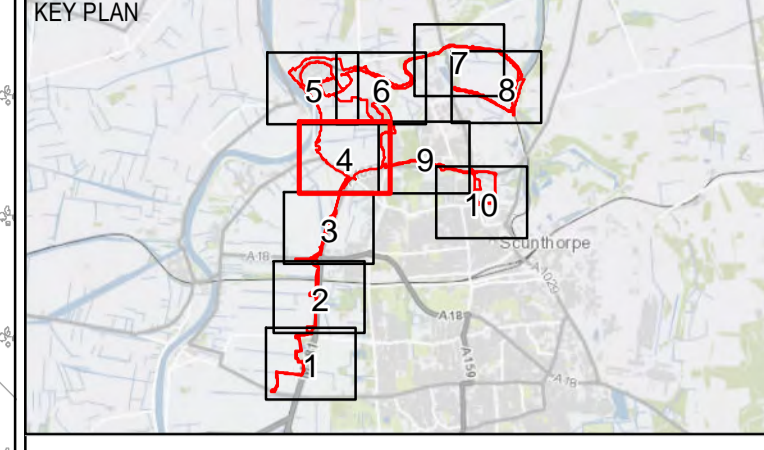

Notes
© Crown copyright and database rights 2021 Ordnance Survey 100035409. You are permitted to use this data solely to enable you to respond to, or interact with, the organisation that provided you with the data. You are not permitted to copy, sub-licence, distribute or sell any of this data to third parties in any form.
Contains OS data © Crown Copyright and database right 2020

- Key
- Order Land - the area within which powers of compulsory acquisition and to take temporary possession can be exercised
 - Order Land - Freehold to be compulsorily acquired and in relation to which it is proposed to extinguish easements, servitudes and other private rights.
 - Order Land - Temporary use of land and in relation to which it is proposed to extinguish easements, servitudes and other private rights.
 - Order Land - New Rights to be compulsorily acquired and in relation to which it is proposed to extinguish easements, servitudes and other private rights.
 - No Acquisition
 - Special Category Land

00	14/03/2022	IM	GE	RB	LH
Rev	Date	Drawn	Checked	Rev'd	App'd

DCO SUBMISSION

INFORMATION

Client



Level 33, Euston Tower, 286 Euston Road, London, NW1 3DP

LD A DESIGN GSDA ERM FICHTNER CONSULTING BUSINESS PARTNERS

BURO HAPPOLD northern planners bowland ecology

Client: NORTH LINCOLNSHIRE GREEN ENERGY PARK LTD
 Consultant: ARDENT
 Project: NORTH LINCOLNSHIRE GREEN ENERGY PARK
 Orig Title: APPLICATION DOCUMENT REFERENCE NO. 4.2 LAND PLAN SHEET 4 OF 10

Planning Inspectorate No:	Scale@A1	
EN010116	1:2500	
Drawn/Designed By:	Checked By:	Approved By:
IMAXIM	G.EACOCK	R.BRADE
Drawing No:	Revision	
NLGP-ARD-XX-XX-DR-Z-0004	00	

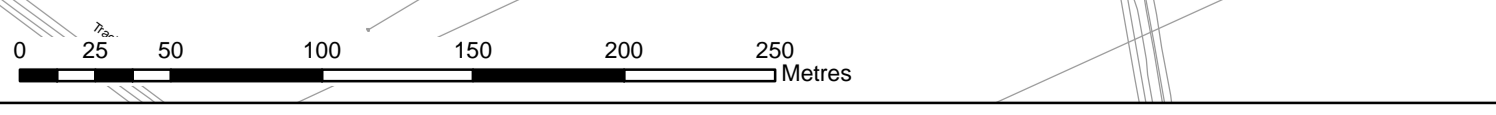

Client: North Lincolnshire Green Energy Park Ltd; Consultant: Ardent; Project: North Lincolnshire Green Energy Park; Orig Title: Application Document Reference No. 4.2 Land Plan Sheet 4 of 10; Drawing No: NLGP-ARD-XX-XX-DR-Z-0004; Revision: 00

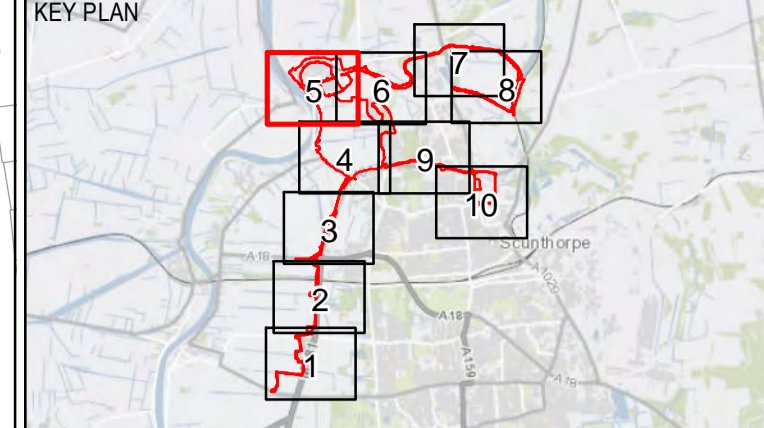

Notes
© Crown copyright and database rights 2021 Ordnance Survey 100035409. You are permitted to use this data solely to enable you to respond to, or interact with, the organisation that provided you with the data. You are not permitted to copy, sub-licence, distribute or sell any of this data to third parties in any form.
Contains OS data © Crown Copyright and database right 2020

- Key
- Order Land - the area within which powers of compulsory acquisition and to take temporary possession can be exercised
 - Order Land - Freehold to be compulsorily acquired and in relation to which it is proposed to extinguish easements, servitudes and other private rights.
 - Order Land - Temporary use of land and in relation to which it is proposed to extinguish easements, servitudes and other private rights.
 - Order Land - New Rights to be compulsorily acquired and in relation to which it is proposed to extinguish easements, servitudes and other private rights.
 - No Acquisition
 - Special Category Land

00	14/03/2022	IM	GE	RB	LH
Rev	Date	Drawn	Checked	Rev'd	App'd

DCO SUBMISSION

INFORMATION

Client



Level 33, Euston Tower, 286 Euston Road, London, NW1 3DP

LD&DESIGN GSDA ERM FICHTNER CONSULTING BUSINESS PARTNERS

BURO HAPPOLD northern planners bowland ecology

Client: NORTH LINCOLNSHIRE GREEN ENERGY PARK LTD
 Consultant: ARDENT
 Project: NORTH LINCOLNSHIRE GREEN ENERGY PARK
 Orig Title: APPLICATION DOCUMENT REFERENCE NO. 4.2 LAND PLAN SHEET 5 OF 10

Planning Inspectorate No:	Scale@A1
EN010116	1:2500
Drawn/Designed By: I.MAXIM	Checked By: G.EACOCK
Approved By: R.BRADE	
Drawing No: NLGEP-ARD-XX-XX-DR-Z-0005	Revision: 00

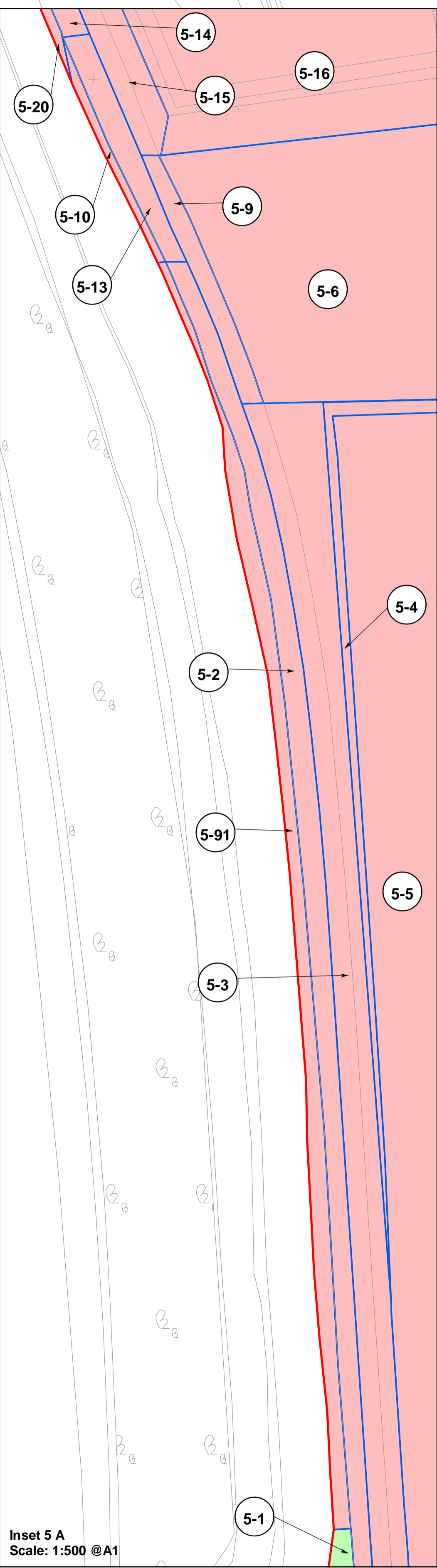

Inset 5 A
Scale: 1:500 @A1

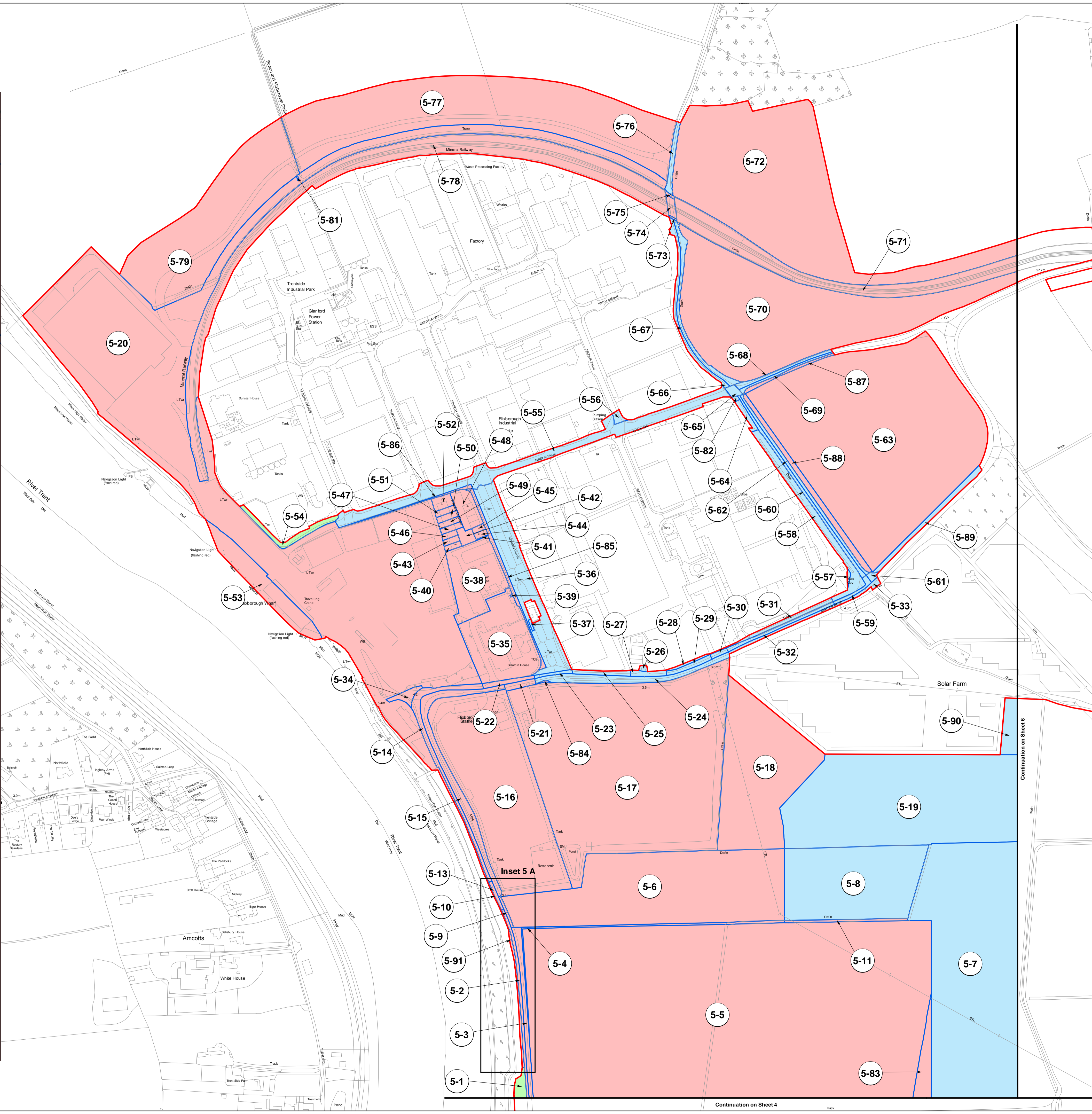

Inset 5 A

Continuation on Sheet 4

Continuation on Sheet 6

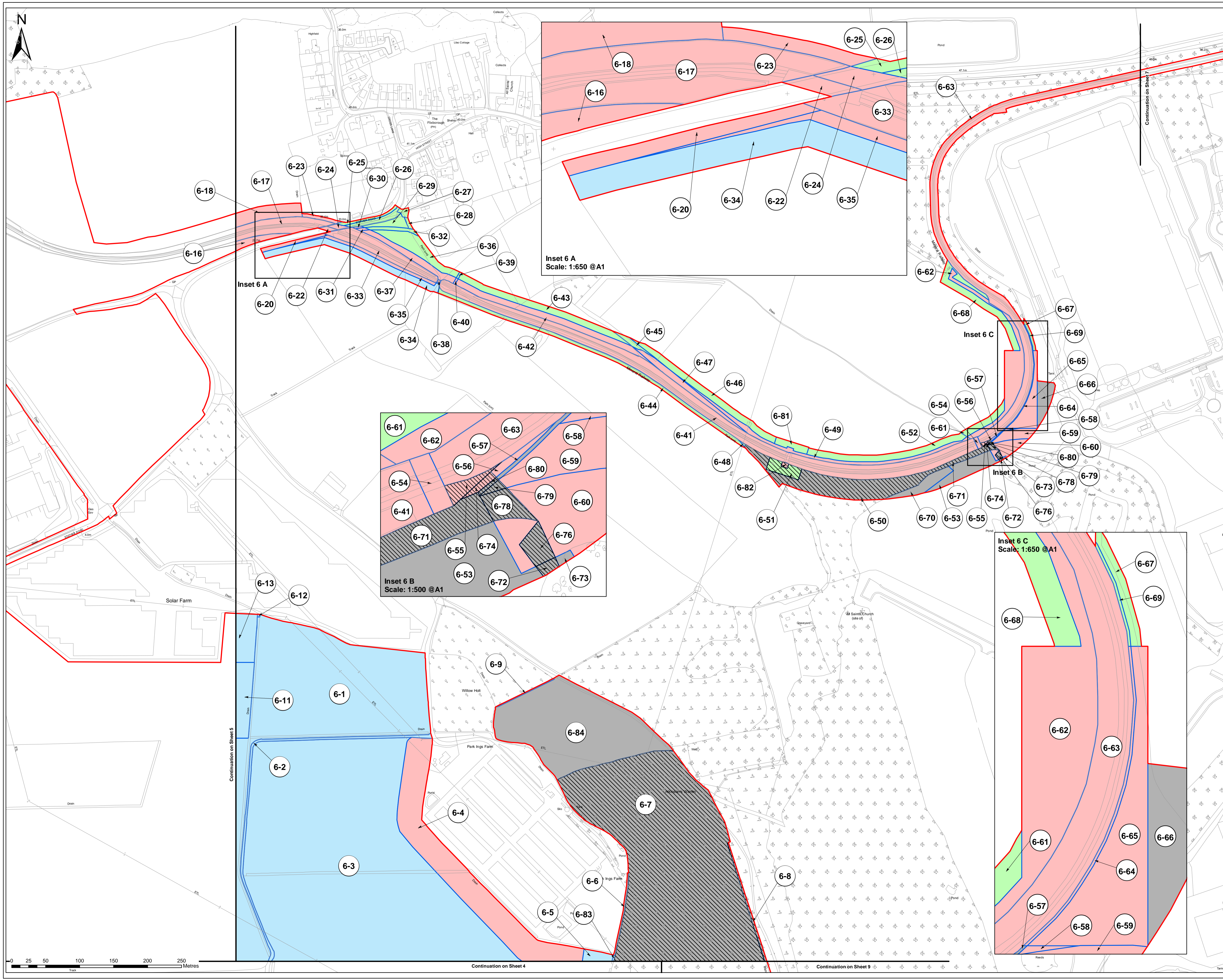

Planning Act 2008
The Infrastructure Planning (Applications: Prescribed forms and Procedure) Regulations 2009
Regulation: 5(2)(f)

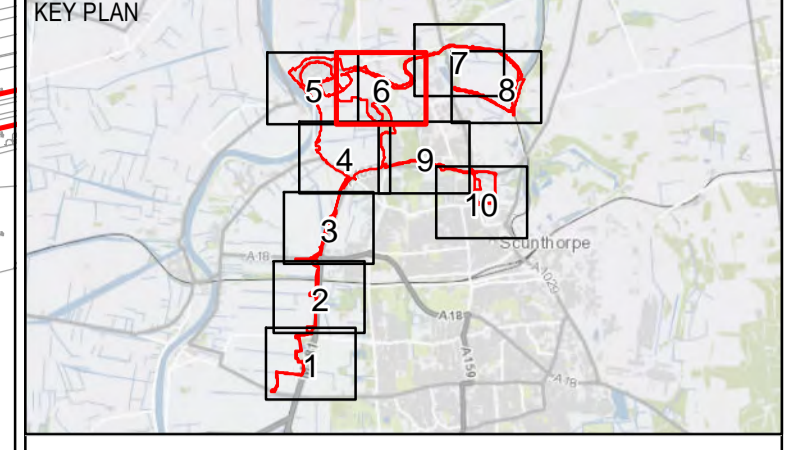

Notes
© Crown copyright and database rights 2021 Ordnance Survey 100035409. You are permitted to use this data solely to enable you to respond to, or interact with, the organisation that provided you with the data. You are not permitted to copy, sub-licence, distribute or sell any of this data to third parties in any form.
Contains OS data © Crown Copyright and database right 2020

- Key
- Order Land - the area within which powers of compulsory acquisition and to take temporary possession can be exercised
 - Order Land - Freehold to be compulsorily acquired and in relation to which it is proposed to extinguish easements, servitudes and other private rights.
 - Order Land - Temporary use of land and in relation to which it is proposed to extinguish easements, servitudes and other private rights.
 - Order Land - New Rights to be compulsorily acquired and in relation to which it is proposed to extinguish easements, servitudes and other private rights.
 - No Acquisition
 - Special Category Land

00	14/03/2022	IM	GE	RB	LH
Rev	Date	Drawn	Checked	Rev'd	App'd

DCO SUBMISSION

INFORMATION

Client

Level 33, Euston Tower, 298 Euston Road, London, NW1 3DP

LD A DESIGN GSDA ERM FICHTNER

BURO HAPPOLD northern planners bowland ecology arcadis

Client: NORTH LINCOLNSHIRE GREEN ENERGY PARK LTD
 Consultant: ARDENT
 Project: NORTH LINCOLNSHIRE GREEN ENERGY PARK
 Orig Title: APPLICATION DOCUMENT REFERENCE NO. 4.2
 LAND PLAN SHEET 6 OF 10

Planning Inspectorate No:	Scale@A1
EN010116	1:2500
Drawn/Designed By: I.MAXIM	Checked By: G.EACOCK
Approved By: R.BRADE	Revision: 00
Drawing No: NLGEP-ARD-XX-XX-DR-Z-0006	

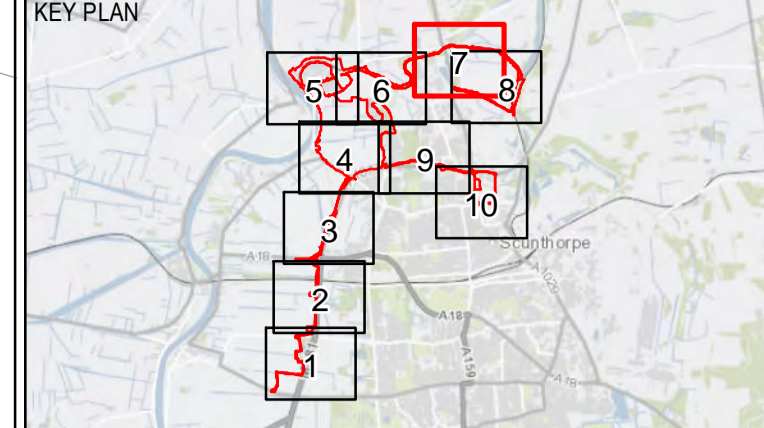

Notes
© Crown copyright and database rights 2021 Ordnance Survey 100035409. You are permitted to use this data solely to enable you to respond to, or interact with, the organisation that provided you with the data. You are not permitted to copy, sub-licence, distribute or sell any of this data to third parties in any form.
Contains OS data © Crown Copyright and database right 2020

- Key
- Order Land - the area within which powers of compulsory acquisition and to take temporary possession can be exercised
 - Order Land - Freehold to be compulsorily acquired and in relation to which it is proposed to extinguish easements, servitudes and other private rights.
 - Order Land - Temporary use of land and in relation to which it is proposed to extinguish easements, servitudes and other private rights.
 - Order Land - New Rights to be compulsorily acquired and in relation to which it is proposed to extinguish easements, servitudes and other private rights.
 - No Acquisition
 - Special Category Land

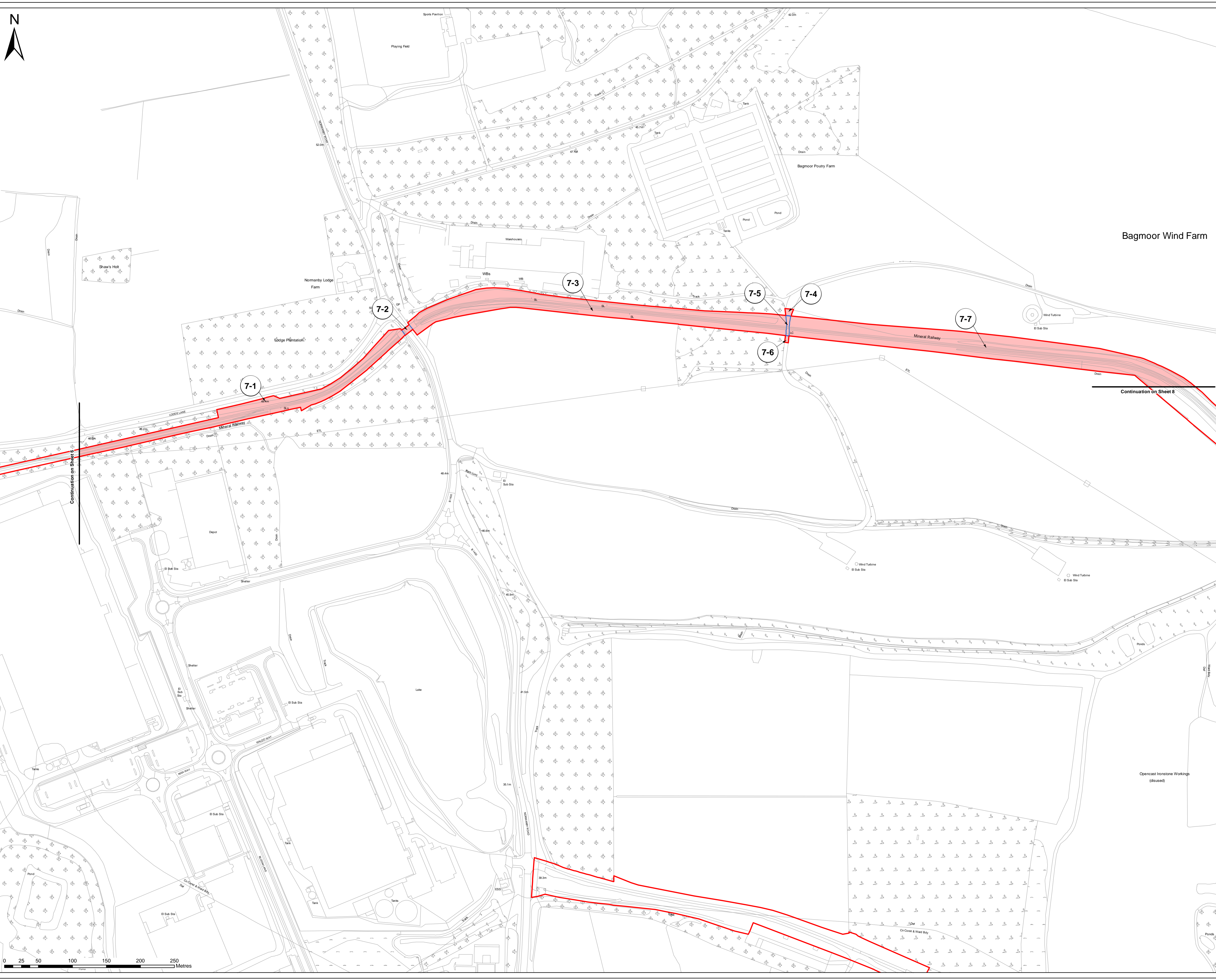

00	14/03/2022	IM	GE	RB	LH
Rev	Date	Drawn	Checked	Rev'd	App'd

DCO SUBMISSION

INFORMATION

Client



Level 33, Euston Tower, 286 Euston Road, London, NW1 3DP

LD&DESIGN GSDA ERM FICHTNER

BURO HAPPOLD northern planners bowland ecology

Client: NORTH LINCOLNSHIRE GREEN ENERGY PARK LTD
 Consultant: ARDENT
 Project: NORTH LINCOLNSHIRE GREEN ENERGY PARK
 Drg Title: APPLICATION DOCUMENT REFERENCE NO. 4.2
 LAND PLAN SHEET 7 OF 10

Planning Inspectorate No:	Scale@A1	
EN010116	1:2500	
Drawn/Designed By:	Checked By:	Approved By:
IMAXIM	G.EACOCK	R.BRADE
Drawing No:	Revision	
NLGE-ARD-XX-XX-DR-Z-0007	00	

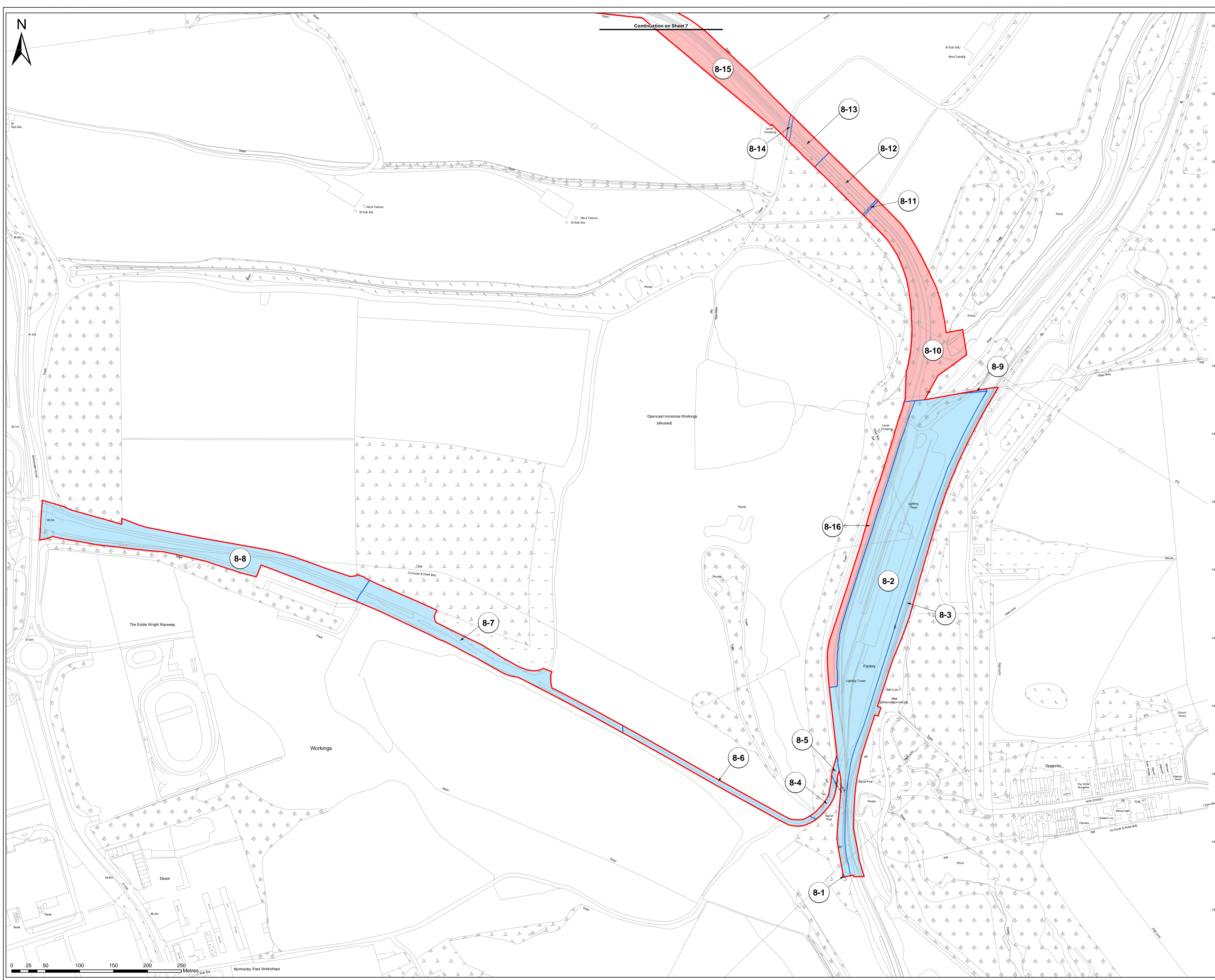

Planning Act 2008
The Infrastructure Planning (Applications: Prescribed forms and Procedure) Regulations 2009
Regulation: 5(2)(i)

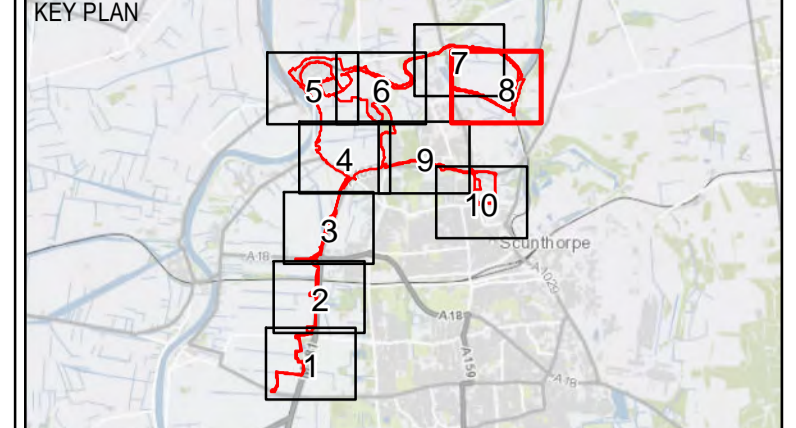

Notes
© Crown copyright and database rights 2021 Ordnance Survey 100035409. You are permitted to use this data solely to enable you to respond to, or interact with, the organisation that provided you with the data. You are not permitted to copy, sub-licence, distribute or sell any of this data to third parties in any form.
Contains OS data © Crown Copyright and database right 2020

- Key**
- Order Land - the area within which powers of compulsory acquisition and to take temporary possession can be exercised
 - Order Land - Freehold to be compulsorily acquired and in relation to which it is proposed to extinguish easements, servitudes and other private rights.
 - Order Land - Temporary use of land and in relation to which it is proposed to extinguish easements, servitudes and other private rights.
 - Order Land - New Rights to be compulsorily acquired and in relation to which it is proposed to extinguish easements, servitudes and other private rights.
 - No Acquisition
 - Special Category Land

00	14/03/2022		IM	GE	RB	LH
Rev	Date		Drawn	CHK'd	Rev'd	Appl'd

DCO SUBMISSION

INFORMATION

Client

Level 33, Euston Tower, 286 Euston Road, London, NW1 3DP

LD&DESIGN **GSDA** **ERM** **FICHTNER**
CONSULTING BUSINESS PARTNERS

BURO HAPPOLD **northern planners** **bowland ecology** **ARCADIS**

Client NORTH LINCOLNSHIRE GREEN ENERGY PARK LTD
Consultant ARDENT
Project NORTH LINCOLNSHIRE GREEN ENERGY PARK
Org Title APPLICATION DOCUMENT REFERENCE NO. 4.2
 LAND PLAN SHEET 8 OF 10

Planning Inspectorate No. EN010116		Scale A1 1:2500
Drawn/Designed By IMAXIM	Checked By G.EACOCK	Approved By R.BRADE
Drawing No. NLGEP-ARD-XX-XX-DR-Z-0008		Revision 00

C:\Users\ard\Documents\North Lincoln Green Energy Park\PE_GIS\GIS\Drawings\ARD\NLGEP\MapDocs\MapDocs\DCO-00-0008-Z-0008.mxd



Continuation on Sheet 6

Inset 9 A

Inset 9 A
Scale: 1:850 @A1

Planning Act 2008
The Infrastructure Planning (Applications: Prescribed forms and Procedure) Regulations 2009
Regulation: 9(2)(b)

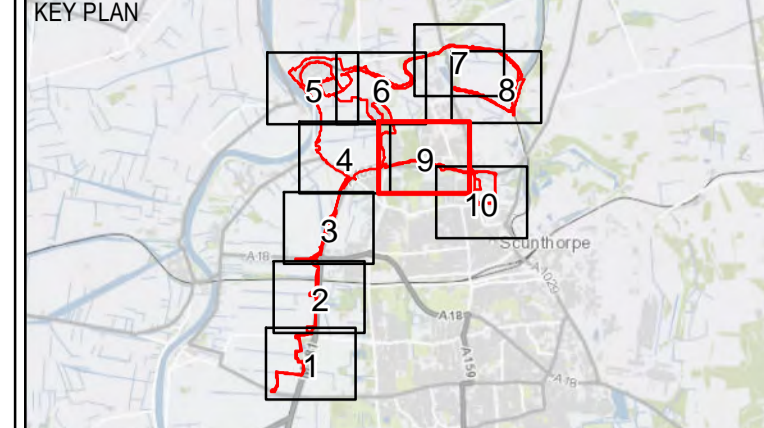

Notes
© Crown copyright and database rights 2021 Ordnance Survey 100035409. You are permitted to use this data solely to enable you to respond to, or interact with, the organisation that provided you with the data. You are not permitted to copy, sub-licence, distribute or sell any of this data to third parties in any form.
Contains OS data © Crown Copyright and database right 2020

- Key
- Order Land - the area within which powers of compulsory acquisition and to take temporary possession can be exercised
 - Order Land - Freehold to be compulsorily acquired and in relation to which it is proposed to extinguish easements, servitudes and other private rights.
 - Order Land - Temporary use of land and in relation to which it is proposed to extinguish easements, servitudes and other private rights.
 - Order Land - New Rights to be compulsorily acquired and in relation to which it is proposed to extinguish easements, servitudes and other private rights.
 - No Acquisition
 - Special Category Land

100	14/03/2022	IM	GE	RB	LH
Rev	Date	Drawn	Checked	Rev'd	App'd

DCO SUBMISSION

INFORMATION

Client

Level 33, Euston Tower, 286 Euston Road, London, NW1 3DP

LDADesign GSDA ERM Fichtner

BURO HAPPOLD northern planners bowland ecology

Client: NORTH LINCOLNSHIRE GREEN ENERGY PARK LTD
 Consultant: ARDENT
 Project: NORTH LINCOLNSHIRE GREEN ENERGY PARK
 Dwg Title: APPLICATION DOCUMENT REFERENCE NO. 4.2
 SHEET 9 OF 10

Planning Inspectorate No:	Scale@A1	
EN010116	1:2500	
Drawn/Designed By:	Checked By:	Approved By:
IMAXIM	G.EACOCK	R.BRADE
Drawing No:	Revision	
NLGE-ARD-XX-DR-Z-0009	00	

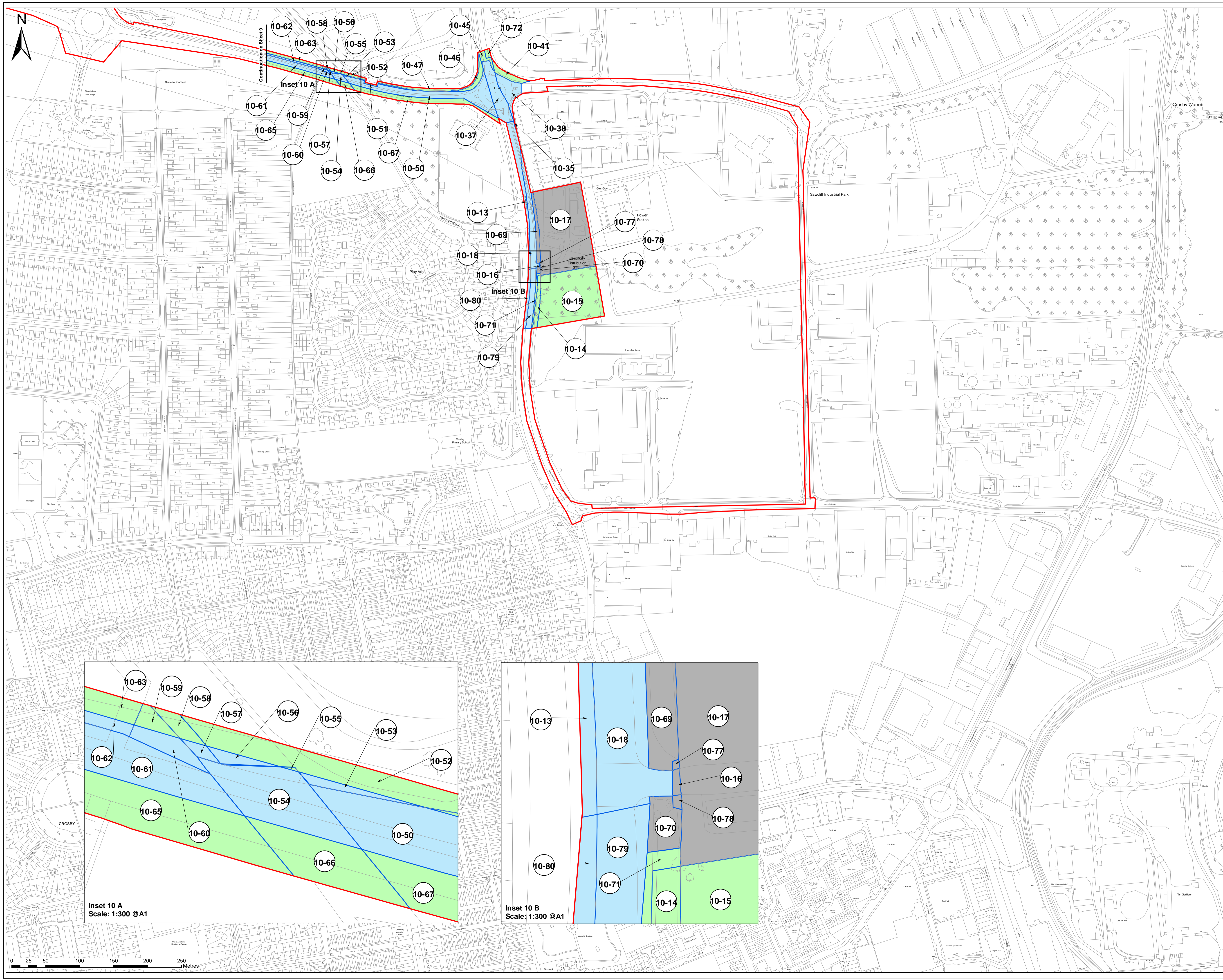

Planning Act 2008
The Infrastructure Planning (Applications: Prescribed forms and Procedure) Regulations 2009
Regulation: 5(2)(b)

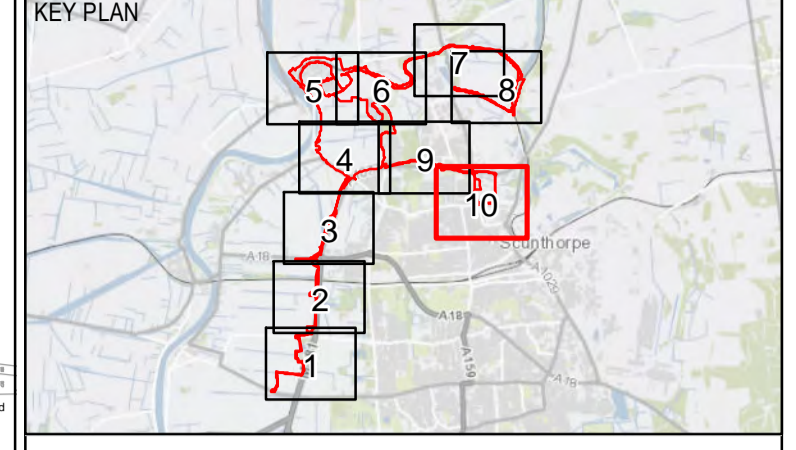

Notes
© Crown copyright and database rights 2021 Ordnance Survey 100035409. You are permitted to use this data solely to enable you to respond to, or interact with, the organisation that provided you with the data. You are not permitted to copy, sub-licence, distribute or sell any of this data to third parties in any form.
Contains OS data © Crown Copyright and database right 2020

- Key
- Order Land - the area within which powers of compulsory acquisition and to take temporary possession can be exercised
 - Order Land - Freehold to be compulsorily acquired and in relation to which it is proposed to extinguish easements, servitudes and other private rights.
 - Order Land - Temporary use of land and in relation to which it is proposed to extinguish easements, servitudes and other private rights.
 - Order Land - New Rights to be compulsorily acquired and in relation to which it is proposed to extinguish easements, servitudes and other private rights.
 - No Acquisition
 - Special Category Land

00	14/03/2022	IM	GE	RB	LH
Rev	Date	Drawn	Checked	Rev'd	App'd

DCO SUBMISSION

INFORMATION

Client

LD&DESIGN GSDA ERM FICHTNER CONSULTING BUSINESS PARTNERS

BURO HAPPOLD northern planners bowland ecology

Client: NORTH LINCOLNSHIRE GREEN ENERGY PARK LTD
 Consultant: ARDENT
 Project: NORTH LINCOLNSHIRE GREEN ENERGY PARK
 Orig Title: APPLICATION DOCUMENT REFERENCE NO. 4.2
 SHEET 10 OF 10

Planning Inspectorate No:	Scale@A1	
EN010116	1:2500	
Drawn/Designed By:	Checked By:	Approved By:
IMAXIM	G.EACOCK	R.BRADE
Drawing No:	Revision	
NLGE-ARD-XX-XX-DR-Z-0010	00	

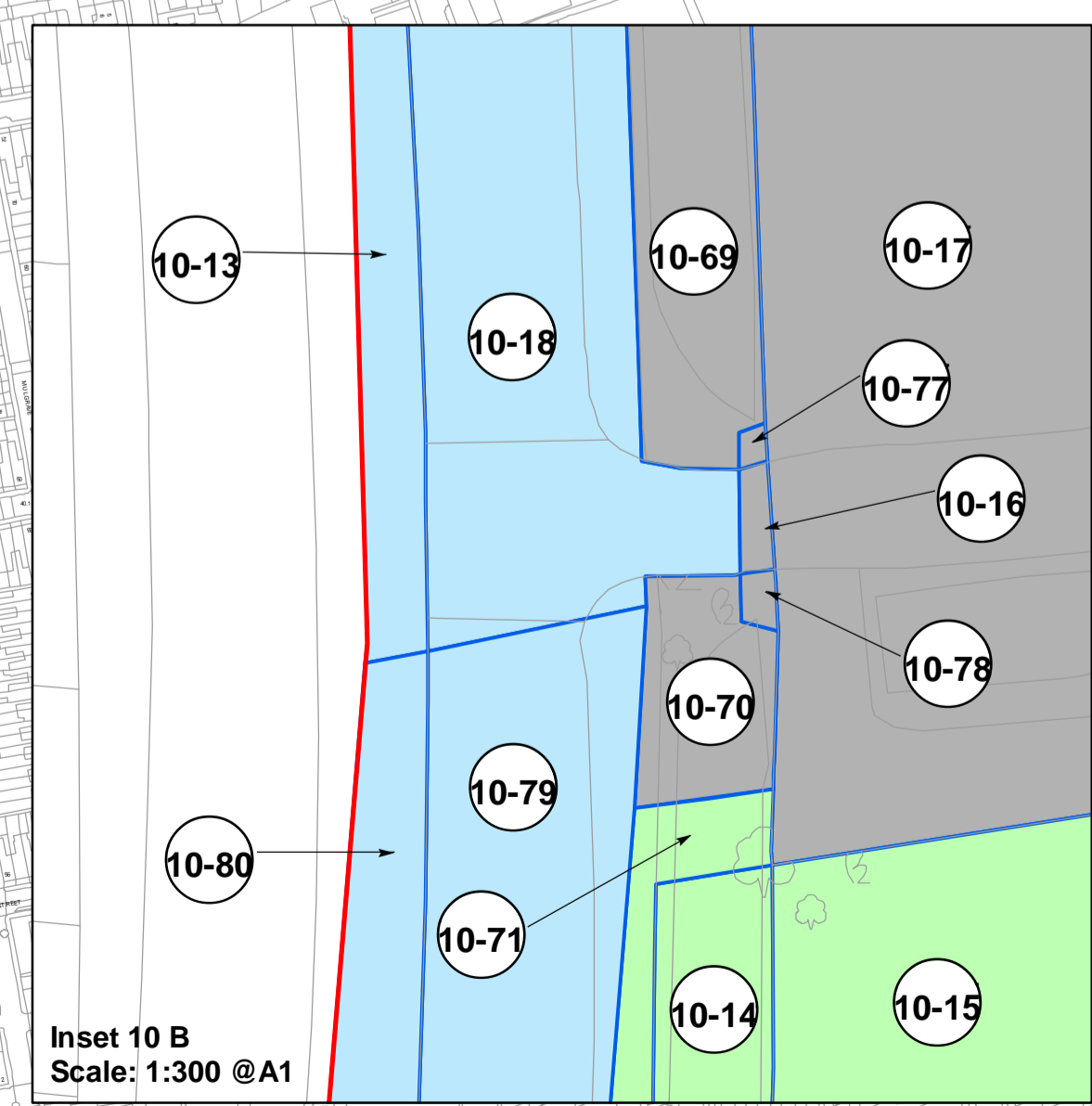
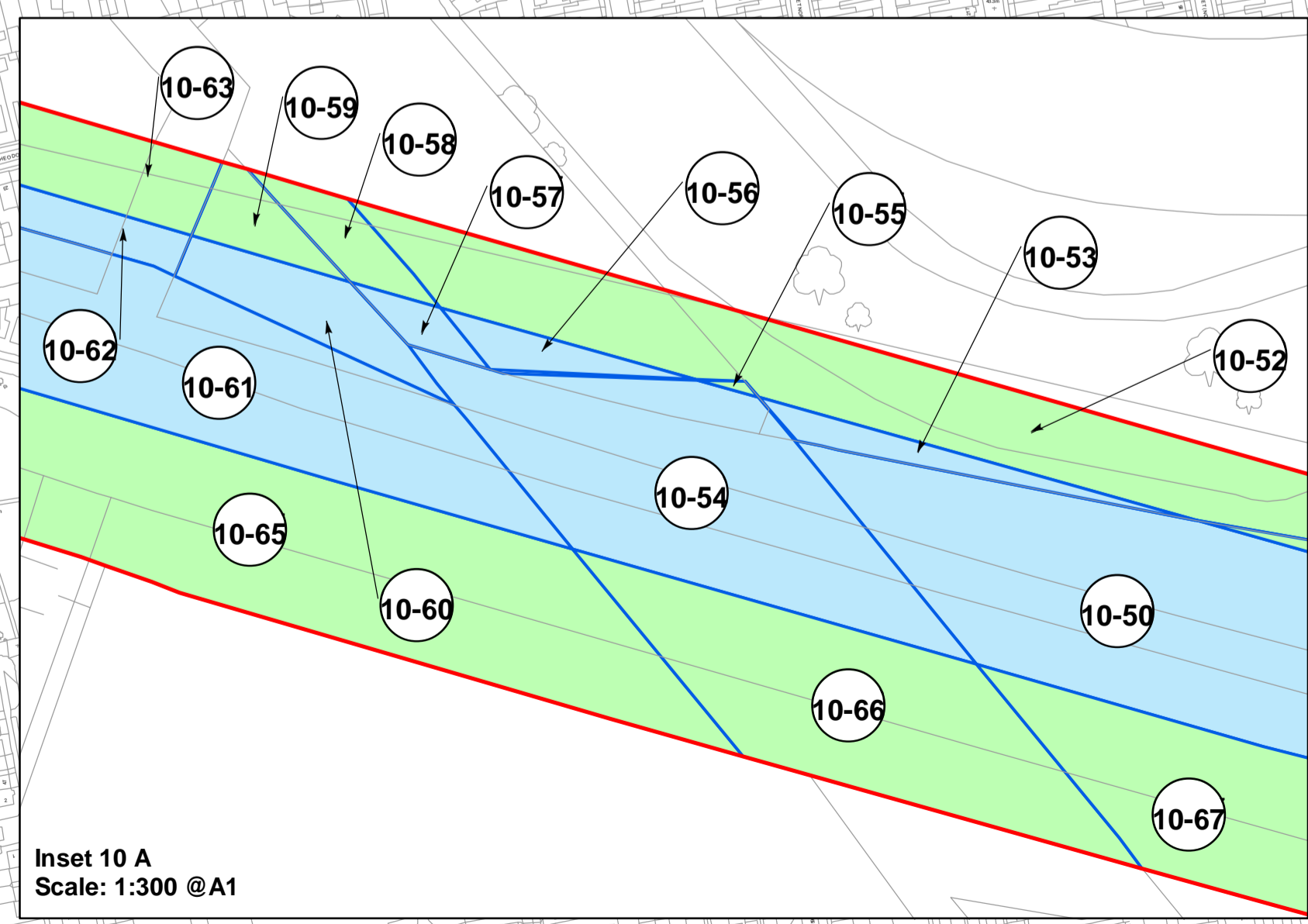

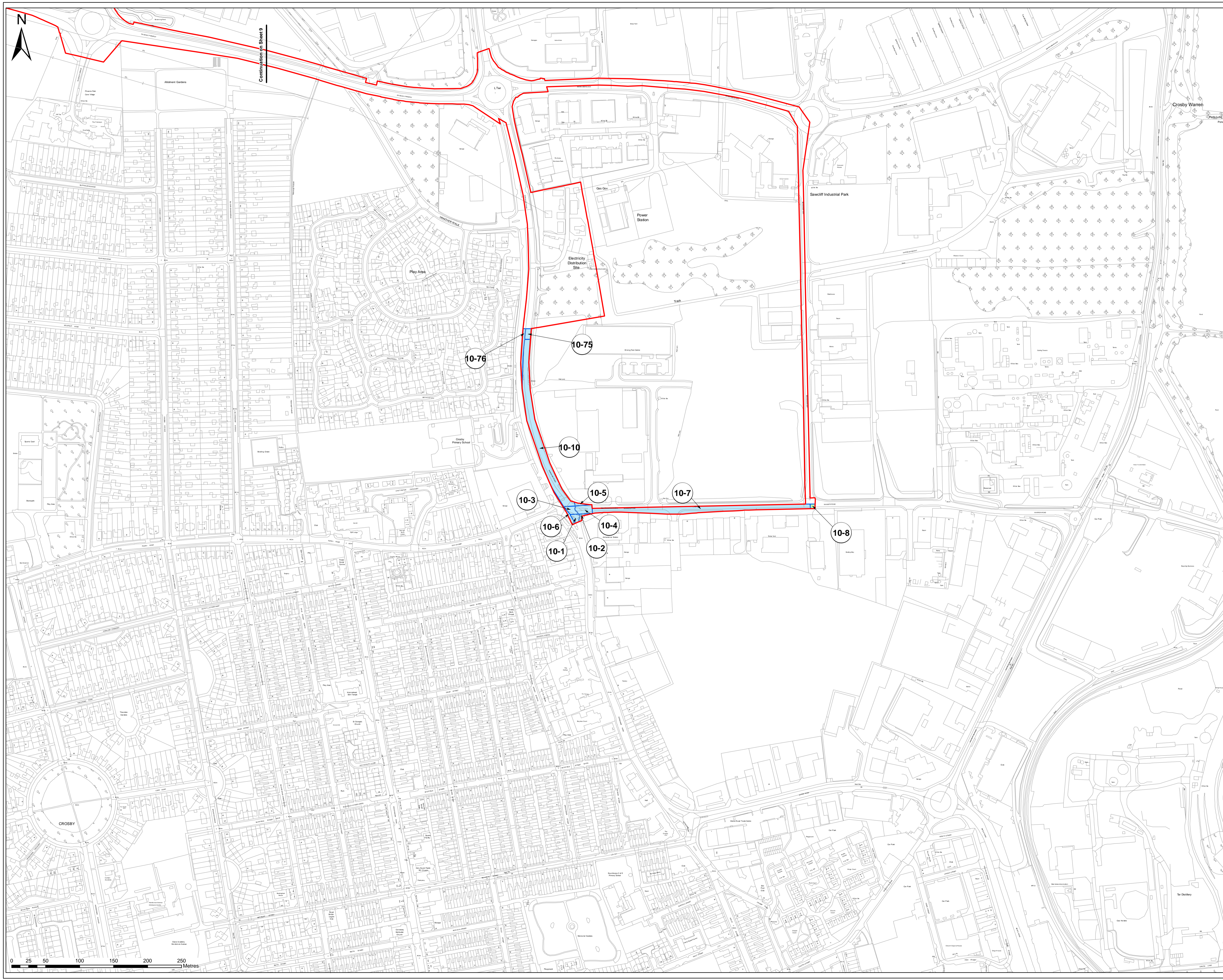

Continuation of Sheet 9

Planning Act 2008
The Infrastructure Planning (Applications: Prescribed forms and Procedure) Regulations 2009
Regulation: 5(2)(b)

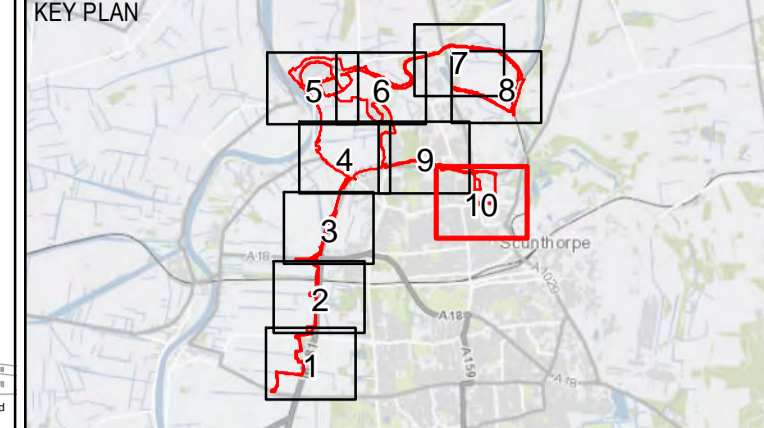

Notes
© Crown copyright and database rights 2021 Ordnance Survey 100035409. You are permitted to use this data solely to enable you to respond to, or interact with, the organisation that provided you with the data. You are not permitted to copy, sub-licence, distribute or sell any of this data to third parties in any form.
Contains OS data © Crown Copyright and database right 2020

- Key
- Order Land - the area within which powers of compulsory acquisition and to take temporary possession can be exercised
 - Order Land - Freehold to be compulsorily acquired and in relation to which it is proposed to extinguish easements, servitudes and other private rights.
 - Order Land - Temporary use of land and in relation to which it is proposed to extinguish easements, servitudes and other private rights.
 - Order Land - New Rights to be compulsorily acquired and in relation to which it is proposed to extinguish easements, servitudes and other private rights.
 - No Acquisition
 - Special Category Land

00	14/03/2022	IM	GE	RB	LH
Rev	Date	Drawn	Checked	Rev'd	App'd

DCO SUBMISSION

INFORMATION

Client



NORTH LINCOLNSHIRE GREEN ENERGY PARK
Level 33, Euston Tower, 286 Euston Road, London, NW1 3DP

LD A DESIGN GSDA ERM FICHTNER CONSULTING BUSINESS PARTNERS

BURO HAPPOLD northern planners bowland ecology arcadis

Client: **NORTH LINCOLNSHIRE GREEN ENERGY PARK LTD**
 Consultant: **ARDENT**
 Project: **NORTH LINCOLNSHIRE GREEN ENERGY PARK**
 Title: **APPLICATION DOCUMENT REFERENCE NO. 4.2 LAND PLAN SHEET 10A OF 10**

Planning Inspectorate No:	EN010116	Scale@A1:	1:2500
Drawn/Designed By:	IMAXIM	Checked By:	G.EACOCK
Approved By:	R.BRADE	Drawing No:	NLGEP-ARD-XX-DR-Z-0010A
Revision:			00



C:\Users\ardent\Documents\Projects\NorthLincolnshireGreenEnergyPark\PEP\GIS\DCO\Drawings\ARD\DCO\DCO_Sheet10A_2022.dwg

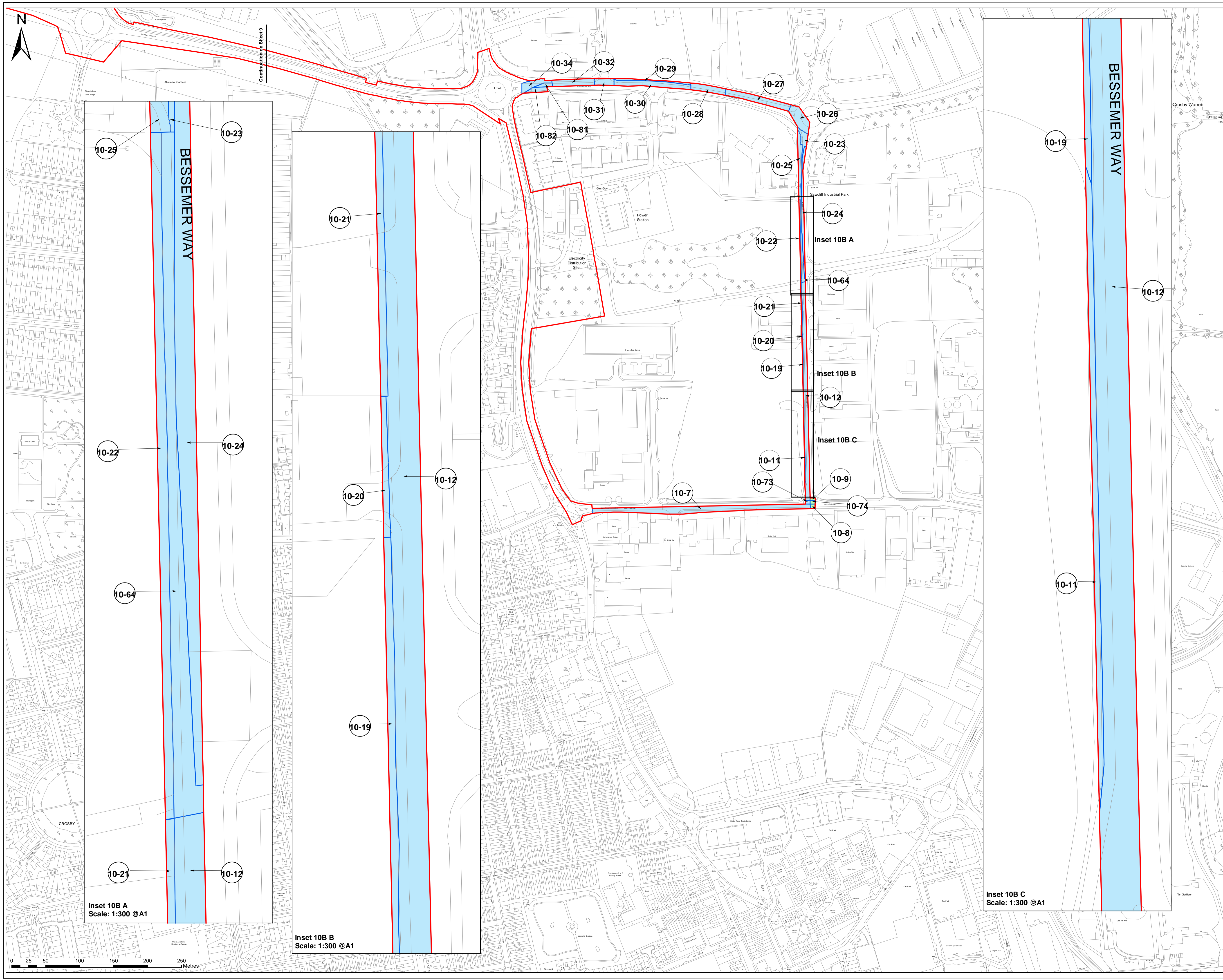

Planning Act 2008
The Infrastructure Planning (Applications: Prescribed forms and Procedure) Regulations 2009
Regulation: 5(2)(b)

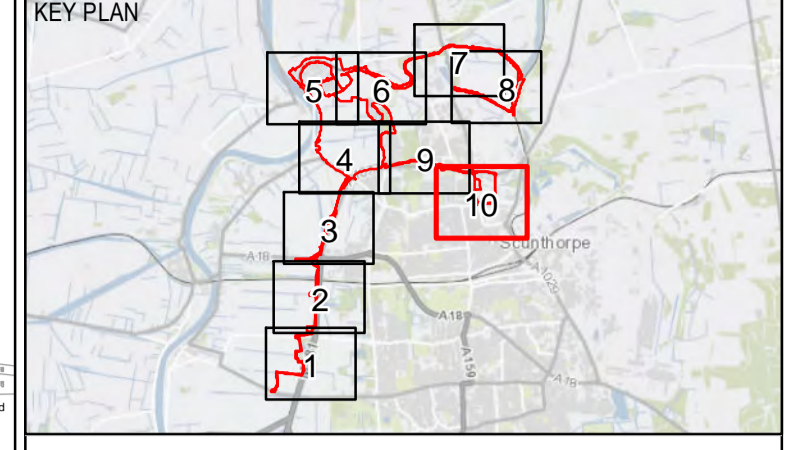

Notes
© Crown copyright and database rights 2021 Ordnance Survey 100035409. You are permitted to use this data solely to enable you to respond to, or interact with, the organisation that provided you with the data. You are not permitted to copy, sub-licence, distribute or sell any of this data to third parties in any form.
Contains OS data © Crown Copyright and database right 2020

- Key
- Order Land - the area within which powers of compulsory acquisition and to take temporary possession can be exercised
 - Order Land - Freehold to be compulsorily acquired and in relation to which it is proposed to extinguish easements, servitudes and other private rights.
 - Order Land - Temporary use of land and in relation to which it is proposed to extinguish easements, servitudes and other private rights.
 - Order Land - New Rights to be compulsorily acquired and in relation to which it is proposed to extinguish easements, servitudes and other private rights.
 - No Acquisition
 - Special Category Land

Rev	Date	Drawn	Chk'd	Rev'd	App'd
00	14/03/2022				IM GE RB LH

DCO SUBMISSION

INFORMATION

Client

Level 33, Euston Tower, 286 Euston Road, London, NW1 3DP

LD A DESIGN GSDA ERM FICHTNER CONSULTING BUSINESS PARTNERS

BURO HAPPOLD northern planners bowland ecology ardent

Client: NORTH LINCOLNSHIRE GREEN ENERGY PARK LTD
 Consultant: ARDENT
 Project: NORTH LINCOLNSHIRE GREEN ENERGY PARK
 Drg Title: APPLICATION DOCUMENT REFERENCE NO. 4.2 LAND PLAN SHEET 10B OF 10

Planning Inspectorate No:	Scale@A1
EN010116	1:2500
Drawn/Designed By: I.MAXIM	Checked By: G.EACOCK
Approved By: R.BRADE	
Drawing No: NLGEP-ARD-XX-DR-Z-0010B	Revision: 00

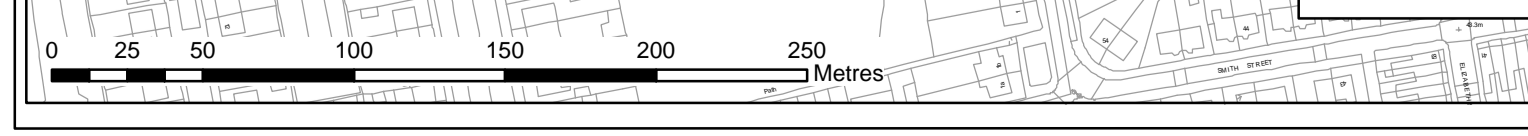

Inset 10B A
Scale: 1:300 @A1

Inset 10B B
Scale: 1:300 @A1

Inset 10B C
Scale: 1:300 @A1

Continuation of Sheet 9